

(1) Standard grease fitting (Front grease fitting)

(Unit : mm)

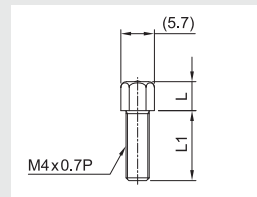

Specification		M4x0.7P		
Applied model	Grease fitting model	Symbol	L	L1
SBI 15	1N	None	7	6
	1D	DD, ZZ	5	9
	1Z	KK	5	12
	1F	ZZDF	5	16

(Unit : mm)

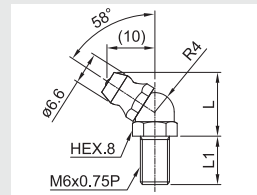

Specification		M6x0.75P, Standard		
Applied model	Grease fitting model	Symbol	L	L1
SBI20-35	IA2N	None	14	8
	IA2D	DD, ZZ	14	10
	IA2Z	KK	14	13
	IA2NF	DF	14	15
	IA2DF	DFDD, DFZZ	14	17
	IA2ZF	DFKK	14	20

(Unit : mm)

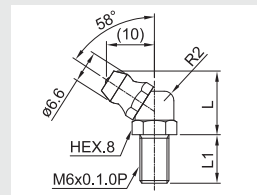

Specification		M6x1.0P, Order made		
Applied model	Grease fitting model	Symbol	L	L1
SBI20-35	IE2N	None	14	8
	IE2D	DD, ZZ	14	10
	IE2Z	KK	14	13
	IE2NF	DF	14	15
	IE2DF	DFDD, DFZZ	14	17
	IE2ZF	DFKK	14	20

(Unit : mm)

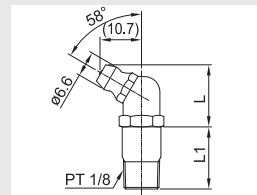

Specification		PT 1/8		
Applied model	Grease fitting model	Symbol	L	L1
SBI45	4N	None	17	13
	4D	DD, KK, ZZ	17	16
	4NF	DF	17	21
	4DF	DFDD, DFKK, DFZZ	17	24

* M6x0.75P is standard grease fitting for SBI20-35 type. If you need M6x1.0P, please contact SBC.

(2) Side grease fitting

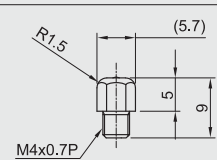

Specification	M4x0.7P
Applied model	SBI 15
Grease fitting model	S1N

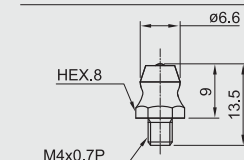

Specification	M4x0.7P
Applied model	SBI 20, 25
Grease fitting model	S2N

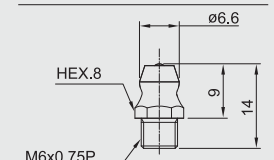

Specification	M6x0.75P
Applied model	SBI 30, 35, 45
Grease fitting model	S3N

(3) FS nipple connector for side grease fitting (FL, FLL flange type only)

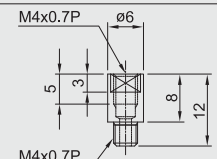

Specification	M4x0.7P
Applied model	SBI 15
Grease fitting model	S1C

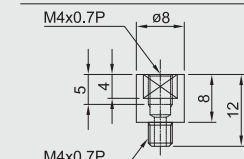

Specification	M4x0.7P
Applied model	SBI 20, 25
Grease fitting model	S2C

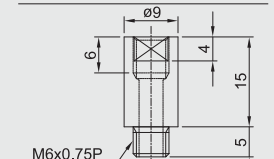

Specification	M6x0.75P
Applied model	SBI 30, 35, 45
Grease fitting model	S3C

(4) Copper pipe

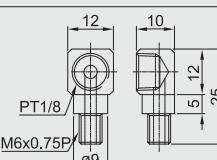

Input size	PT1/8
Output size	M6x0.75P
Applied model	SBI 20
Grease fitting model	S2P

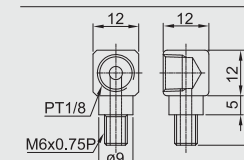

Input size	PT1/8
Output size	M6x0.75P
Applied model	SBI 25, 30, 35
Grease fitting model	S3P

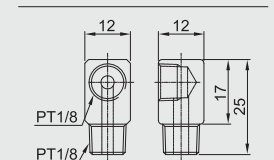

Input size	PT1/8
Output size	PT1/8
Applied model	SBI 45
Grease fitting model	S4P

SBG Series products are no longer in production. Data below is for reference only!

Linear Rail System

Linear Rail System

SBG Standard linear rail system

SBG Standard linear rail system

(1) Standard grease fitting (Front grease fitting)

(Unit : mm)

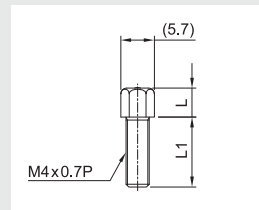

Specification		M4x0.7P		
Applied model	Grease fitting model	Symbol	L	L1
SBG(S) 15	1N	None	7	6
	1D	DD, ZZ	5	9
	1Z	KK	5	12

(Unit : mm)

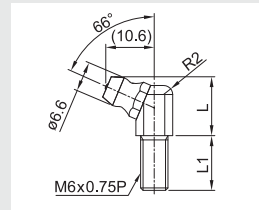

Specification		M6x0.75P, Standard		
Applied model	Grease fitting model	Symbol	L	L1
SBG(S) 20-35	GA2N	None	15	9.5
	GA2D	DD, ZZ	15	12.5
	GA2Z	KK	15	15.5
SPG(S) 20-35	GA2NF	DF	15	17.5
	GA2DF	DFDD, DFKK	15	19.5
	GA2ZF	DFZZ	15	20.5

(Unit : mm)

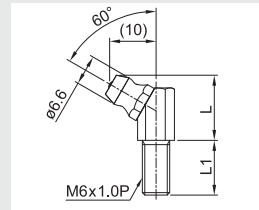

Specification		M6x1.0P, Order made		
Applied model	Grease fitting model	Symbol	L	L1
SBG(S) 20-35	GE2N	None	15	9.5
	GE2D	DD, ZZ	15	12.5
	GE2Z	KK	15	15.5
SPG(S) 20-35	GE2NF	DF	15	17.5
	GE2DF	DFDD, DFKK	15	19.5
	GE2ZF	DFZZ	15	20.5

(Unit : mm)

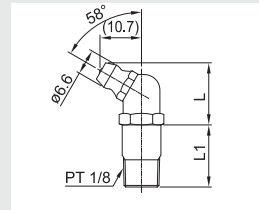

Specification		PT 1/8		
Applied model	Grease fitting model	Symbol	L	L1
SBG(S) 45-65	4N	None	17	13
	4D	DD, KK, ZZ	17	16
	4NF	DF	17	21
	4DF	DFDD, DFKK, DFZZ	17	24

* M6x0.75P is standard grease fitting for SBG(S)20-35 type. If you need M6x1.0P, please contact SBC.

(2) Side grease fitting

Specification	M4x0.7P	Specification	M4x0.7P	Specification	M6x0.75P	Specification	PT1/8
Applied model	SBG(S) 15	Applied model	SBG(S) 20-25	Applied model	SBG(S) 30-45	Applied model	SBG 55-65
Grease fitting model	S1N	Grease fitting model	S2N	Grease fitting model	S3N	Grease fitting model	S4N

(3) FS nipple connector for side grease fitting (FL, FLL flange type only)

Specification	M4x0.7P	Specification	M4x0.7P	Specification	M6x0.75P
Applied model	SBG(S) 15	Applied model	SBG(S) 20, 25	Applied model	SBG(S) 30-45
Grease fitting model	S1C	Grease fitting model	S2C	Grease fitting model	S3C

(4) Copper pipe

Input size	PT1/8	Input size	PT1/8	Input size	PT1/8
Output size	M6x0.75P	Output size	M6x0.75P	Output size	PT1/8
Applied model	SBG(S),SPG(S)20	Applied model	SBG(S),SPG(S)25-35	Applied model	SBG(S) 45-65
Grease fitting model	S2P	Grease fitting model	S3P	Grease fitting model	S4P